

NOTES:

1. MATERIAL: BRASS
2. FINISH: CLEAN  
ALL DIMENSIONS APPLY AFTER FINISH.
3. MATERIAL AND FINISH MUST COMPLY WITH  
CURRENT ROHS LEGISLATION.
4. BREAK ALL SHARPS.

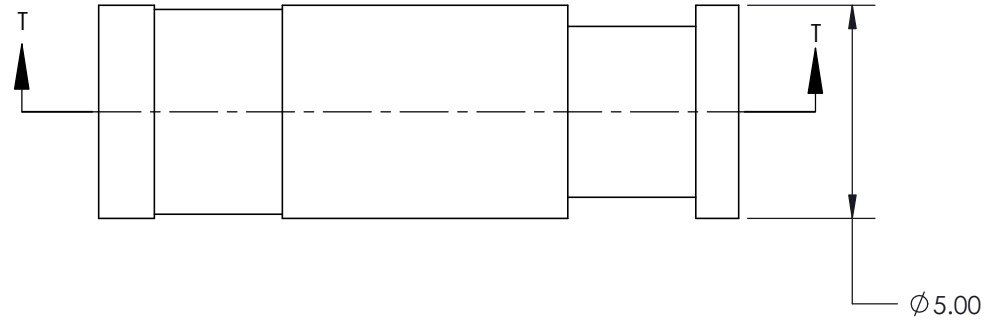
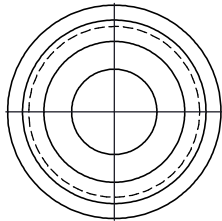
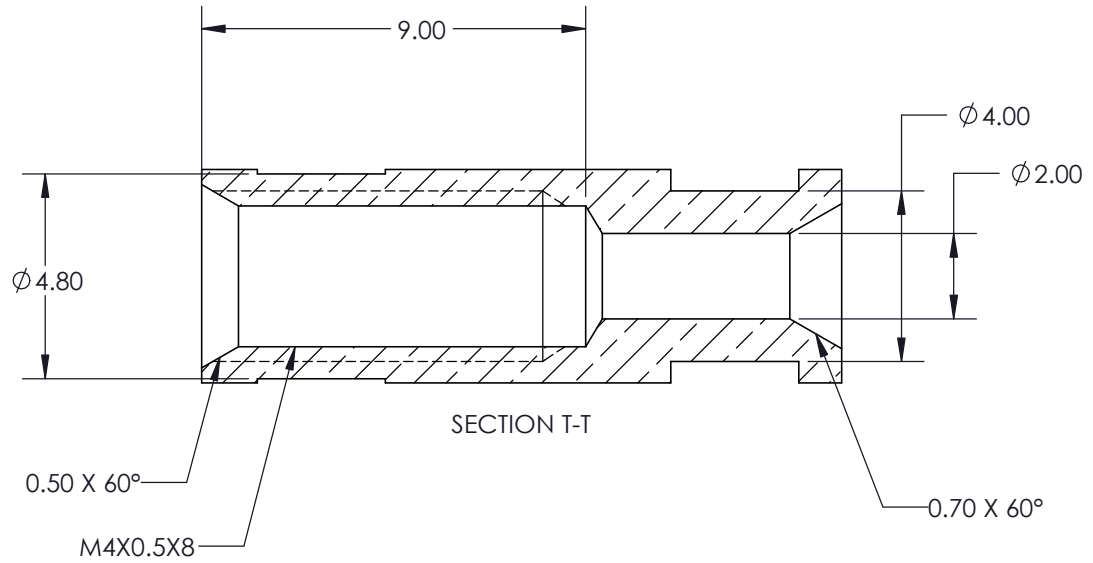

REVISIONS		
REV.	DESCRIPTION	DATE
1	INITIAL DRAWING	16/10/14
2	UPDATED THREAD TO M4 FINE	16/10/14
00-000		27/11/2014

MASS: SEE NOTES	DIMENSIONS ARE IN MILLIMETERS STD TOLERANCES: X±0.1 X.X±0.1 X.XX±0.10 ANGLES: ±0.5°		
MATERIAL: SEE NOTES			
FINISH: SEE NOTES			
	ENG.:	R. JONES	16/10/14
	DRAFT:	R. JONES	16/10/14
	APPR.:	R. JONES	16/10/14

	<b>RepRap Pro</b>	
	PROJECT: DUAL HOT END	
BOWDEN START		
SIZE <b>A4</b>	DWG NO. <b>106</b>	REV <b>00-000</b>
SCALE: 6:1		SHEET 1 OF 1