

Arm drive PSI assembly

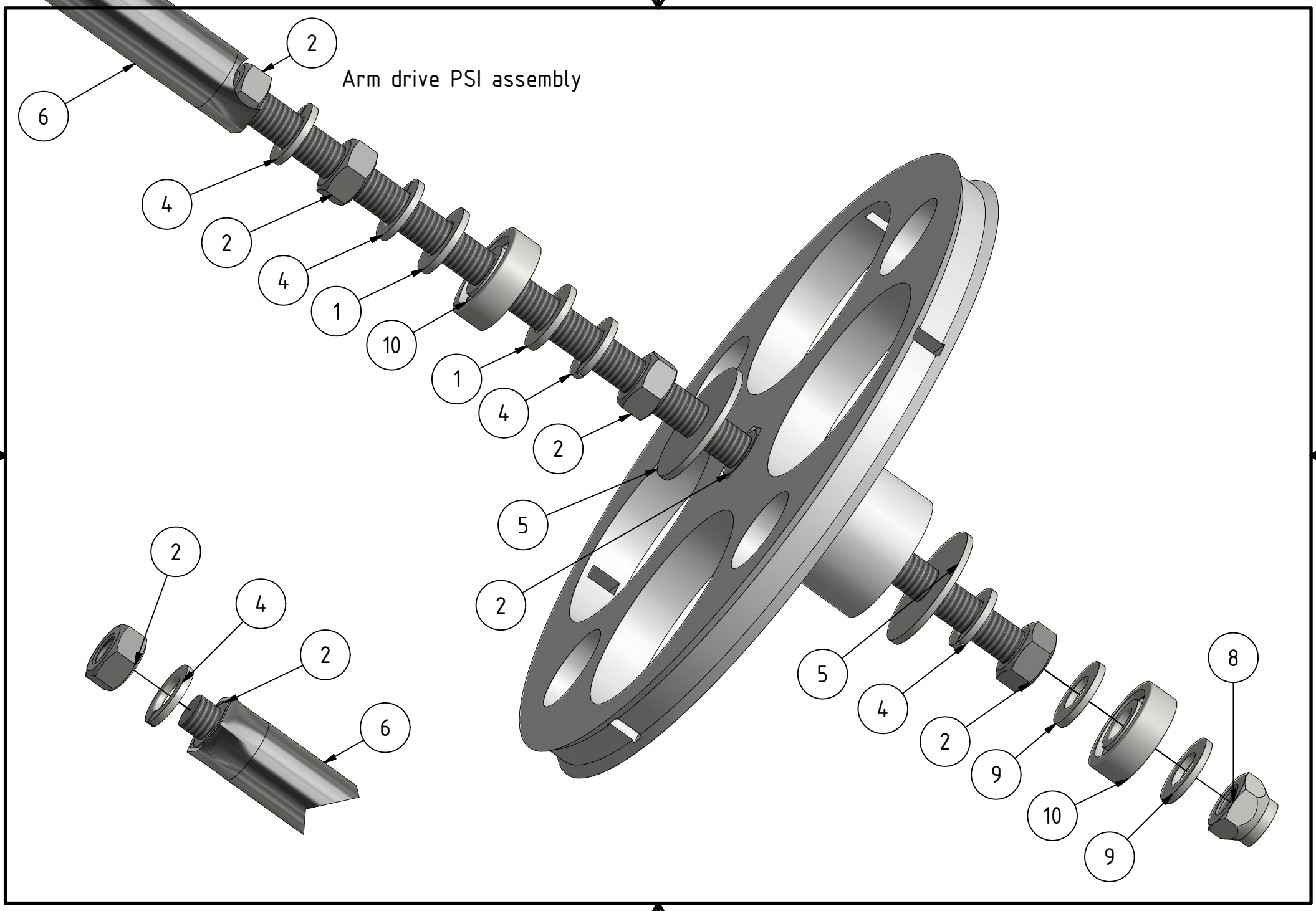

Bill of Materials			
Part	Qty	Partname	Description
1	2	DIN 126 - 9	M8 washers
2	7	ISO 4032 - M8	M8 nuts
3	1	07-drivewheel_rod	printed part
4	5	DIN 128 - A8	M8 spring wahsers
5	2	M8 Unterlegscheibe 28mm	M8 washers 28mm
6	1	15mm Stahlrohr 440mm	15mm x 1mm steel/copper pipe, 440mm
7	1	Gewindestange 8mm	threaded rod M8 ,
8	1	ANSI B18.16.3M - Property Class 5 and 10 - Metric M8 x 1.25 Nichtmetallisch	M8 nylon lock nut
9	2	DIN 125 - A 8,4	M8 washers
10	2	DIN 625 SKF - SKF 608	bearing 608